

# Zephyr™ Drying Gun

313005B

ENG

***For use with waterborne paints only.  
Not for use in explosive atmospheres.***

175 psi (1.2 MPa, 12 bar) Maximum Working Pressure - Gun

125 psi (0.9 MPa, 8.6 bar) Maximum Working Pressure - Stand



## Important Safety Instructions

Read all warnings and instructions in this manual.  
Save these instructions.

### Model 289956

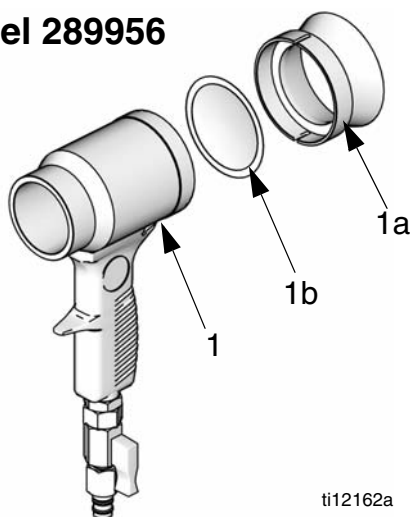

Ref.	Part No.	Description	Qty
1	289956	GUN, drying	1
1a	289987	DIFFUSER	1
1b*	----	FILTER	1
2	289957	STAND, drying gun	1

--- Not sold individually.

\* Order Kit 289986 for replacement filters, five (5) per pack.

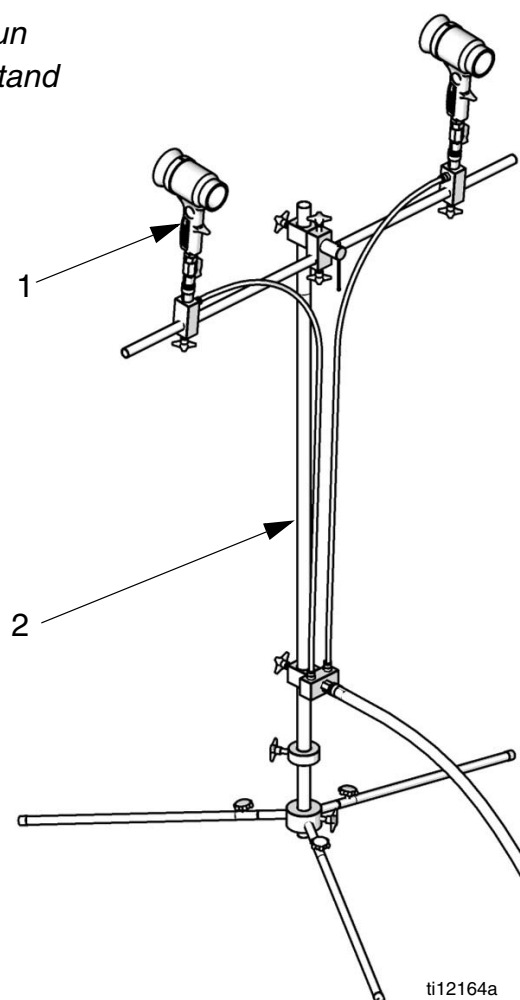



### Kit 289958

(Includes two guns and one stand)

## Warnings

The following warnings are for the setup, use, grounding, maintenance, and repair of this equipment. The exclamation point symbol alerts you to a general warning and the hazard symbol refers to procedure-specific risk. Refer back to these warnings. Additional, product-specific warnings may be found throughout the body of this manual where applicable.

 <b>WARNING</b>	
	<p><b>EQUIPMENT MISUSE HAZARD</b></p> <p>Misuse can cause death or serious injury.</p> <ul style="list-style-type: none"> <li>• Do not operate the unit when fatigued or under the influence of drugs or alcohol.</li> <li>• Do not exceed the maximum working pressure or temperature rating of the lowest rated system component. See <b>Technical Data</b> in all equipment manuals.</li> <li>• Use fluids and solvents that are compatible with equipment wetted parts. See <b>Technical Data</b> in all equipment manuals. Read fluid and solvent manufacturer's warnings. For complete information about your material, request MSDS forms from distributor or retailer.</li> <li>• Check equipment daily. Repair or replace worn or damaged parts immediately with genuine manufacturer's replacement parts only.</li> <li>• Do not alter or modify equipment.</li> <li>• Use equipment only for its intended purpose. Call your distributor for information.</li> <li>• Route hoses and cables away from traffic areas, sharp edges, moving parts, and hot surfaces.</li> <li>• Do not kink or over bend hoses or use hoses to pull equipment.</li> <li>• Keep children and animals away from work area.</li> <li>• Comply with all applicable safety regulations.</li> </ul>
	<p><b>PERSONAL PROTECTIVE EQUIPMENT</b></p> <p>You must wear appropriate protective equipment when operating, servicing, or when in the operating area of the equipment to help protect you from serious injury, including eye injury, inhalation of toxic fumes, burns, and hearing loss. This equipment includes but is not limited to:</p> <ul style="list-style-type: none"> <li>• Protective eyewear</li> <li>• Clothing and respirator as recommended by the fluid and solvent manufacturer</li> <li>• Gloves</li> <li>• Hearing protection</li> </ul>

## Assemble Stand

1. Attach legs (2a) and center pole (2c) to the stand base (2b). Adjust height as needed, from 8-83 in. (20 - 210 cm).
2. Put the main air manifold (2d) and the mounting bar bracket (2e) on the center pole (2c) at desired height.
3. Insert the mounting bar (2f) through the mounting bar bracket (2e).

**NOTE:** Use the adjustment knobs on the mounting bar bracket (2e) to set the height, gun angle (360°), and mounting bar angle (360°).

4. Put the gun air manifolds (2g) at desired location on the mounting bar (2f).
5. Use quick couplers (2h) to connect guns to the gun air manifolds (2g).
6. For each gun, attach one end of air hose to the air inlet (D) on the gun air manifold (2g). Attach the other end of hose to the air outlet (E) on the main air manifold (2d).

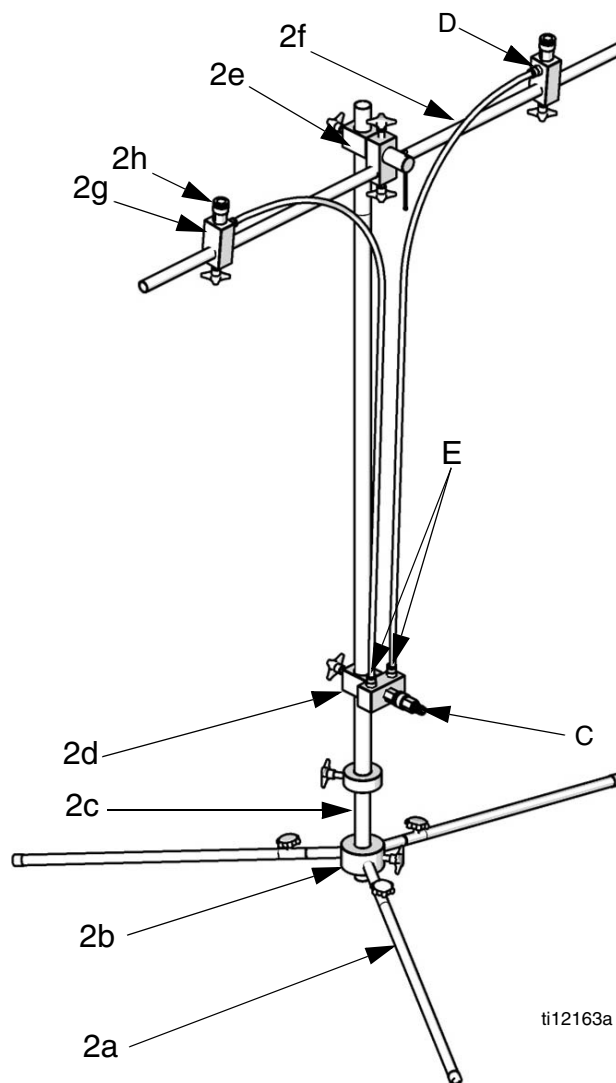

ti12163a

FIG. 1

## Installation and Operation

1. To use stand: Assemble stand and adjust stand height and direction as necessary. See **Assemble Stand**, page 3.
2. Connect a clean, dry, filtered air supply to the gun air inlet (A) or the stand air inlet (C).

**NOTE:**

- Be sure the air hose is solvent resistant and properly pressure rated for your system.
  - Blow out the air hose before connecting it to the gun.
3. Tighten all threaded connections before each use.
  4. Make sure the gun filter is clean. See , page 4.
  5. Set inlet air pressure from 10 - 60 psi (0.1-0.4 MPa, 1-4 bar).
  6. Hold gun (or adjust stand) approximately 12 to 20 inches (30- 50 cm) from surface.
  7. Open the gun air supply shut-off valve (B, see FIG. 2).
  8. Spray at an angle from above, in the same direction as the airflow in the booth.

**NOTE:** To minimize airborne dust, never aim gun at the floor while spraying.

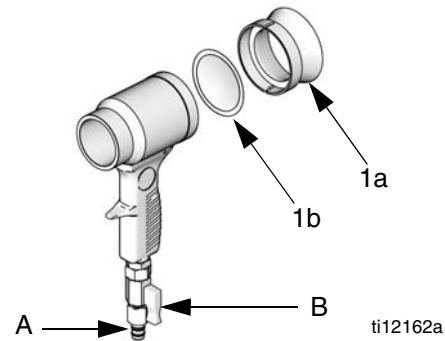

**FIG. 2**

## Clean Gun and Filter

**NOTE:** Do not immerse gun in solvent.

1. Disconnect air supply from gun.
2. Remove the diffuser (1a) and filter (1b).
3. Clean filter with soft brush and compatible solvent. Replace filter if damaged or if still clogged after cleaning.
4. Use a rag moistened in solvent to wipe outside of gun body (1) and diffuser (1a).

## Technical Data

Working Pressure.....	10-60 psi (0.07- 0.4 MPa, 0.7- 4 bar)
Maximum Working Pressure	
Gun .....	175 psi (1.2 MPa, 12 bar)
Stand .....	125 psi (0.9 MPa, 9 bar)
Air Consumption @ 60 psi (0.4, MPa, 4 bar) .....	17.5 scfm
Sound Data*	
Sound Power at 60 psi (0.4, MPa, 4 bar) .....	88.18 dB (A)
Sound Pressure at 60 psi (0.4, MPa, 4 bar) .....	85.26 dB (A)
Weight (with male inlet fitting) .....	484.3 g (19.4 oz)

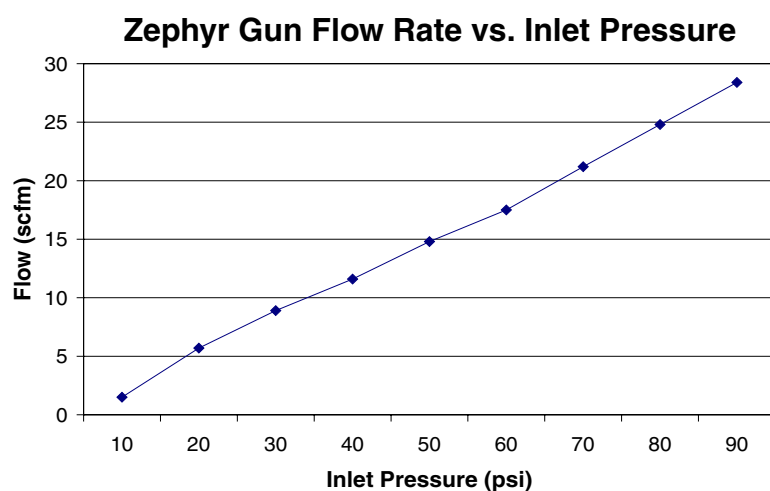

\* All readings were taken with the air shut-off valve fully open at the assumed operator position. Sound power was tested per ISO 9614-2.

# 1 Year Limited Warranty

Sharpe warrants this product to the original user against defective material or workmanship for a period of 1 year from the date of purchase.

Sharpe reserves the right to determine whether the part or parts failed because of defective material, workmanship, or other causes. Failures caused by accident, alteration, or misuse are not covered by this warranty.

Sharpe, at its discretion, will repair or replace products covered under this warranty free of charge. Repairs or replacements of products covered under this warranty are warranted for the remainder of the original warranty period.

Sharpe or its authorized service representatives must perform all warranty repairs. Any repair to the product by unauthorized service representatives voids this warranty. The rights under this warranty are limited to the original user and may not be transferred to subsequent owners.

This warranty is in lieu of all other warranties, expressed or implied, including warranties of merchantability and fitness for a particular purpose. Some states do not allow the exclusion or limitations of incidental or consequential damages, so the above limitations may not apply to you.

## Sharpe Information

**TO PLACE AN ORDER**, contact your SHARPE distributor or call 1-800-742-7731 or visit our website at [www.sharpe1.com](http://www.sharpe1.com).

## Product Registration

Thank you for the purchase of your Sharpe® product. We greatly appreciate your business.

Important reasons to register your product:

- Registration enables Sharpe to notify you if there is a problem with your product.
- Improved Product Development - Your input helps us continue to design products that meet your needs.

For the most up-to-date information and to register your product, please go to [www.sharpe1.com](http://www.sharpe1.com) and click on "Register Product."

*All written and visual data contained in this document reflects the latest product information available at the time of publication. Graco reserves the right to make changes at any time without notice.*

Original instructions. This manual contains English. MM 313005

**SHARPE MANUFACTURING • P.O. BOX 1441, MINNEAPOLIS, MN 55440-1441**  
**1-800-742-7731, [www.sharpe1.com](http://www.sharpe1.com)**

Copyright 2008, Graco Inc. is registered to ISO 9001

**1-800-742-7731, [www.sharpe1.com](http://www.sharpe1.com)**  
Revised 02/2011