

In-Line Filters and Coalescers with Overnight Drains

310611E

Air Filter with Overnight Drain

Part No. 22601

Maintenance

To maintain maximum filtering efficiency and to avoid excessive pressure drop, the filter must be kept clean. Bowl drainage is automatic with the overnight drain, however manual draining can also be done by removing the bowl. A visible coating of dirt on the filter element surface or an excessive pressure drop is an indication that cleaning is necessary.

Cleaning

To clean, it is not necessary to remove the complete filter from the line. Disassembly is simple and does not require tools. Before disassembly, shut off the air supply and depressurize filter. Clean all parts with cleaning solvent and blow out filter body before reassembly. Wash filter element in cleaning solvent and blow out from the inside.

Overnight Drain

The overnight drain is equipped with a float actuated device which automatically ejects liquid contaminants. **When the pressure is off, the unit will drain.**

Specifications

Air Inlet 1/2 in. F.P.T.
 Air Outlet 1/2 in. F.P.T.
 Air Flow Capacity 115 cfm (3.2 m³/min.)
 Max. Operating Pressure 175 psi (1.2 MPa, 12 bar)
 Max. Temperature 150°F (65°C)

Parts

Part No.	Description
22631	Overnight Drain
22638	O-Ring
22640	Baffle Kit
22645	Filter Element

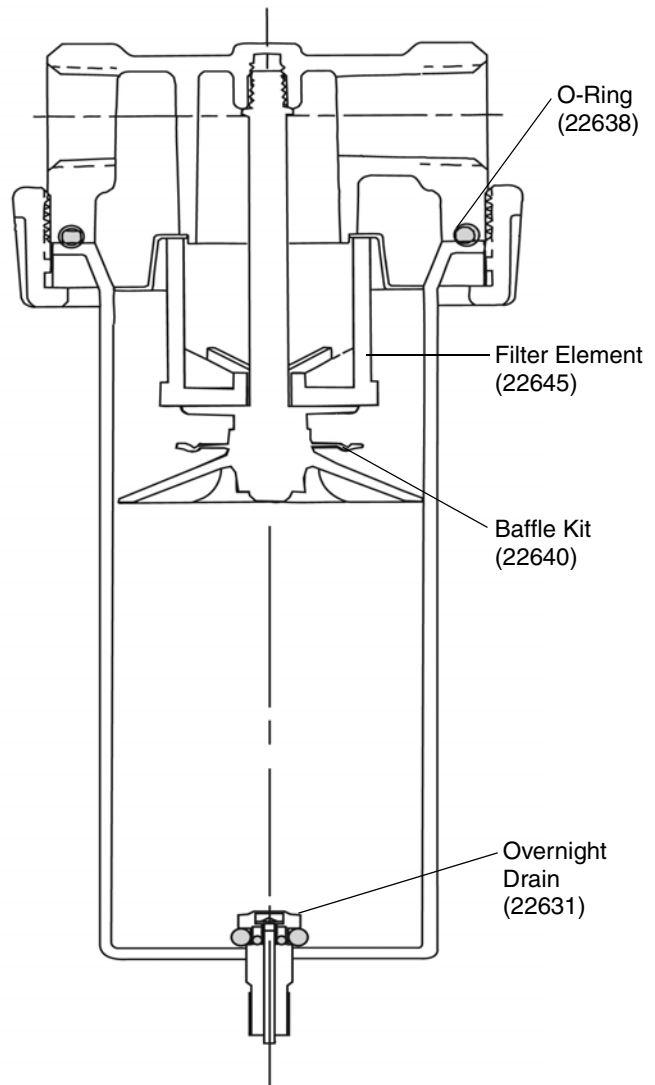

Coalescer with Overnight Drain

(Part No. 22605)

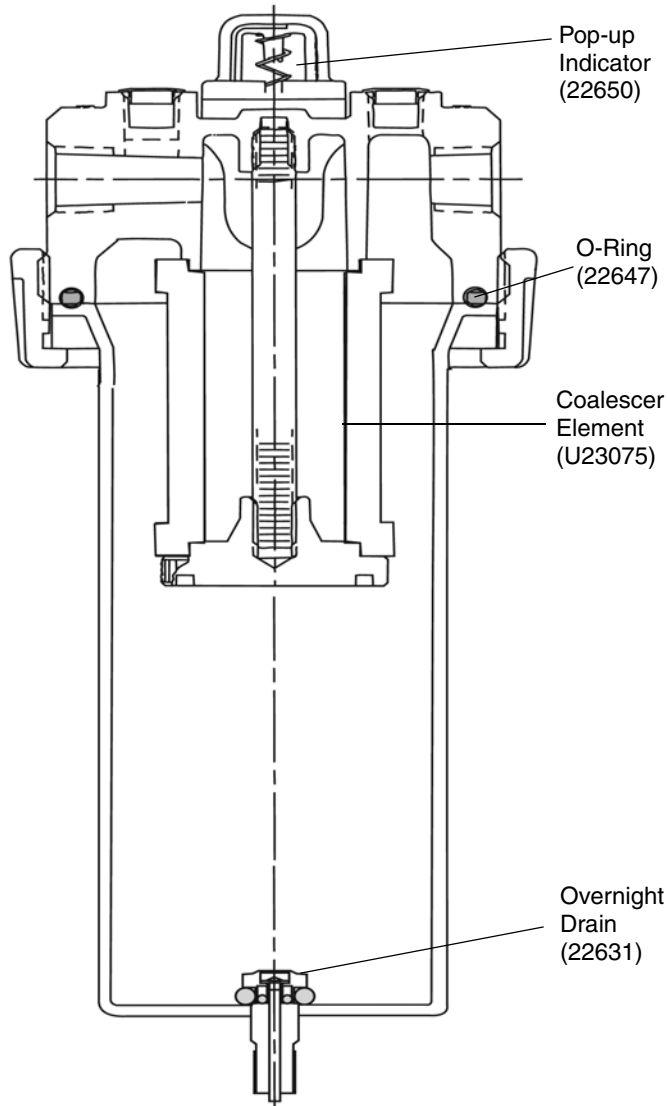

Installation

It is always recommended that a Sharpe air filter be installed upstream of the coalescing filter to remove 5 micron and larger size particles and separate large droplets of moisture from the air line.

Maintenance

Never let the liquid in the bowl reach the base of the coalescing element.

Cleaning

To clean, it is not necessary to remove the complete filter from the line. Disassembly is simple and does not require tools. Before disassembly, shut off the air supply and depressurize coalescer. Clean all parts with cleaning solvent and blow out body before reassembly. Replace coalescing element (part no. 22655).

Pressure Drop Indicator

The differential pressure drop indicator on this unit is designed to provide early detection of a clogged coalescing filter element. As the filter element becomes clogged the red indicator will start to rise while air is flowing through the unit. When the pressure drop across the element reaches 10-12 psi (.07-.08 MPa, 0.7-0.8 bar) the red indicator will be in full view and the element should be replaced. Failure to replace the element when the pressure drop exceeds 10 psi (.07 MPa, 0.7 bar) will affect your air quality and tool efficiency.

Specifications

Air Inlet 1/2 in. F.P.T.

Air Outlet 1/2 in. F.P.T.

Air Flow Capacity 70 cfm (2 m³/min.)

Max. Operating Pressure 175 psi (1.2 MPa, 12 bar)

Max. Temperature 150°F (65°C)

Parts

Part No.	Description
22631	Overnight Drain
22632	Mounting Bracket
22647	O-Ring
22650	Pop-up Indicator Repair Kit
22655	Coalescer Element

Model 707F 3/4 in. In-Line Filter with Overnight Drain

(Part No. 6920)

- Removes all liquids (oil and water)
- Filters Particulate down to 5 microns
- Features large REUSABLE filter element
- Disassemble and clean without tools

Specifications

Air Inlet 3/4 in. F.P.T.

Air Outlet 3/4 in. F.P.T.

Air Flow Capacity 300 cfm (8.4 m³/min.)

Max. Operating Pressure 175 psi (1.2 MPa, 12 bar)

Max. Temperature 150°F (65°C)

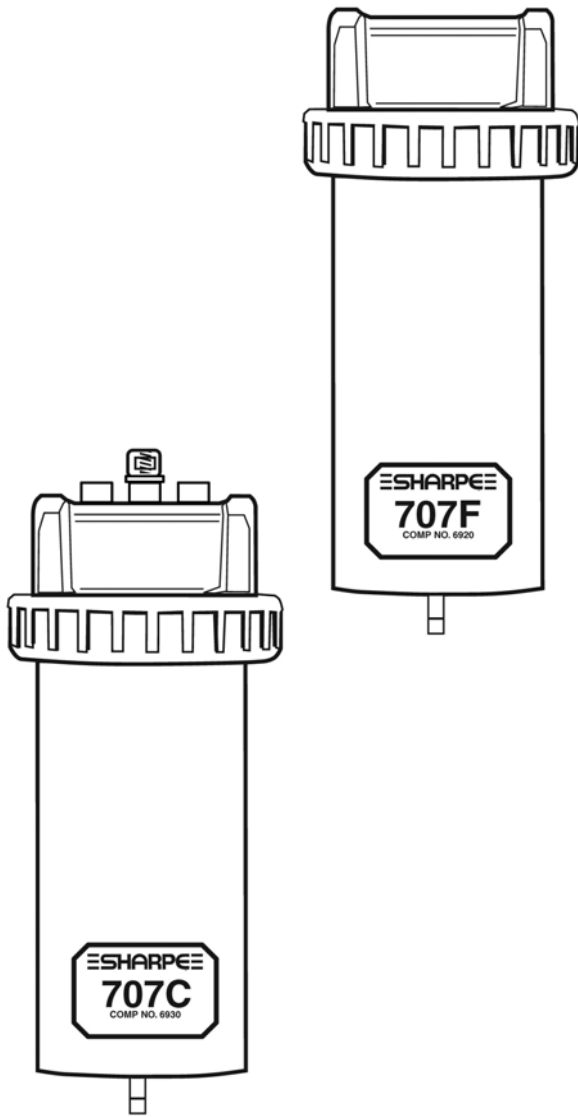

Model 707C 3/4 in. In-Line Coalescer with Overnight Drain

(Part No. 6930)

- Effectively traps fine oil mists and microscopic particles down to 0.01 microns
- Spin-off bowl and coalescer filter element for quick filter changes without tools
- Includes pressure drop indicator
- Recommended downstream of your refrigerated air dryer

Specifications

Air Inlet 3/4 in. F.P.T.

Air Outlet 3/4 in. F.P.T.

Air Flow Capacity 115 cfm (3.2 m³/min.)

Max. Operating Pressure 175 psi (1.2 MPa, 12 bar)

Max. Temperature 150°F (65°C)

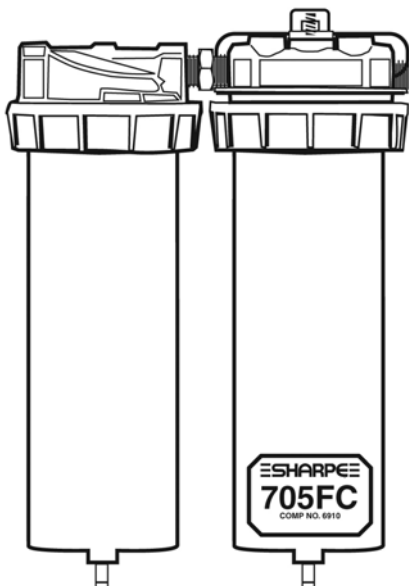

Model 707FC 1/2 in. In-Line Filter & Coalescer with Overnight Drains

(Part No. 6910)

- Designed for use in prep stations
- Clean, dry air without the use of desiccant
- Ideal for protecting moisture sensitive tools
- STAGE 1 provides removal of water and contaminants down to 5 microns
- STAGE 2 provides removal of oil and sub-micronic particles down to 0.01 microns
- Disassemble and clean without tools

Specifications

Air Inlet 1/2 in. F.P.T.

Air Outlet 1/2 in. F.P.T.

Air Flow Capacity 70 cfm (2 m³/min.)

Max. Operating Pressure 175 psi (1.2 MPa, 12 bar)

Max. Temperature 150°F (65°C)

Self-Relieving Air Regulator (Part No. 22604)

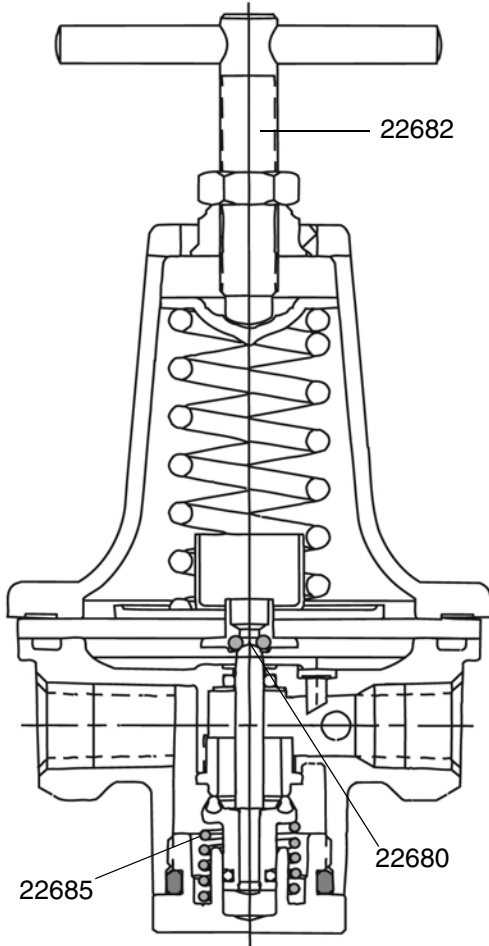

Cleaning

Depressurize regulator, remove bottom plug, spring valve, and diaphragm. Clean parts with denatured alcohol, wipe off seat and blow out body with compressed air. Reassemble parts as a unit and screw into regulator before tightening bottom plug. Make sure disc is in center hole in body. Should regulator continue to malfunction, obtain diaphragm/valve repair kit (part no. 22680) and replace parts provided.

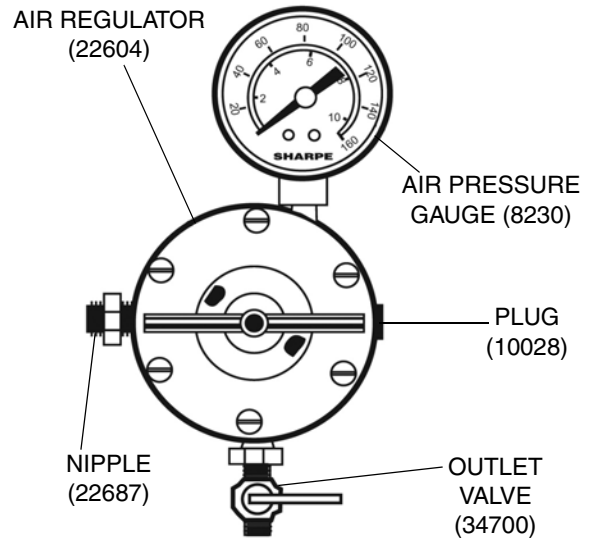

Maintenance

If the air supply is kept clean, this regulator will provide long periods of uninterrupted service. Erratic regulator operation or loss of regulation is most always due to dirt in the diaphragm area and cleaning is in order.

Specifications

Air Inlet 3/8 in. F.P.T.
 Air Outlet 1/4 in. F.P.T. (3 EA.)
 Air Flow Capacity 100 cfm (2.8 m³/min.)
 Max. Operating Pressure 160 psi (1.1 MPa, 11 bar)
 Max. Temperature 150°F (65°C)

Parts

Part No.	Description
8230	Air Pressure Gauge
10028	Plug
22680	Diaphragm/Valve Repair Kit
22682	T-Handle Adjusting Screw
22685	Bottom Spring
22687	3/8 in. x 3/8 in. Nipple
34700	Outlet Valve

All written and visual data contained in this document reflects the latest product information available at the time of publication. Graco reserves the right to make changes at any time without notice.

This manual contains English. MM 310611

SHARPE MANUFACTURING • P.O. BOX 1441, MINNEAPOLIS, MN 55440-1441

1-800-742-7731, www.sharpe1.com

Revised 7/2008