

SELF-RELIEVING FLUID PRESSURE REGULATOR

(PART NO. 1400)

310607C

For use with pressurized cup guns

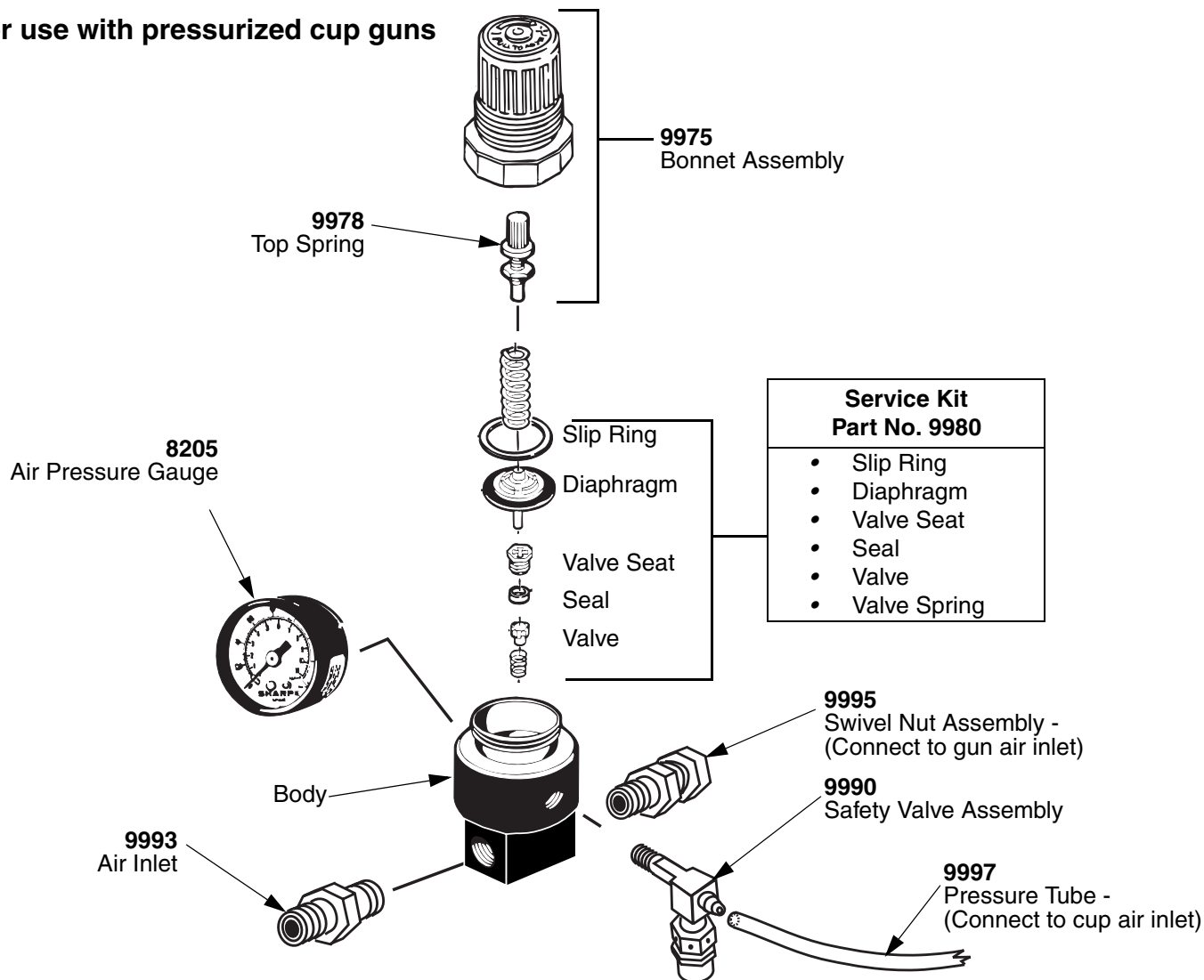

PARTS LIST

Part No.	Description
8205	Gauge
9975	Bonnet Assembly
9978	Top Spring
9990	Safety Valve Assembly
9993	Air Inlet
9995	Swivel Nut Assembly
9997	Pressure Tube

Specifications:

Maximum inlet pressure: 30 psi (0.21 MPa, 2.1 bar)
 Maximum regulated air pressure: 30 psi (0.21 MPa, 2.1 bar)